



Maryland Business Best Practices: Benefits of a Bike Work Culture

Webinar 7.10.20

WEBINAR FAQ

“AS-NEEDED”

- ▶ Select Computer or Phone Audio
- ▶ The Questions window can be used for both technical issues and Q & A
- ▶ All sessions will be recorded and will be available post- webinar at CommuterChoiceMaryland.com
- ▶ Slide decks will also be available at the Commuter Choice Maryland website

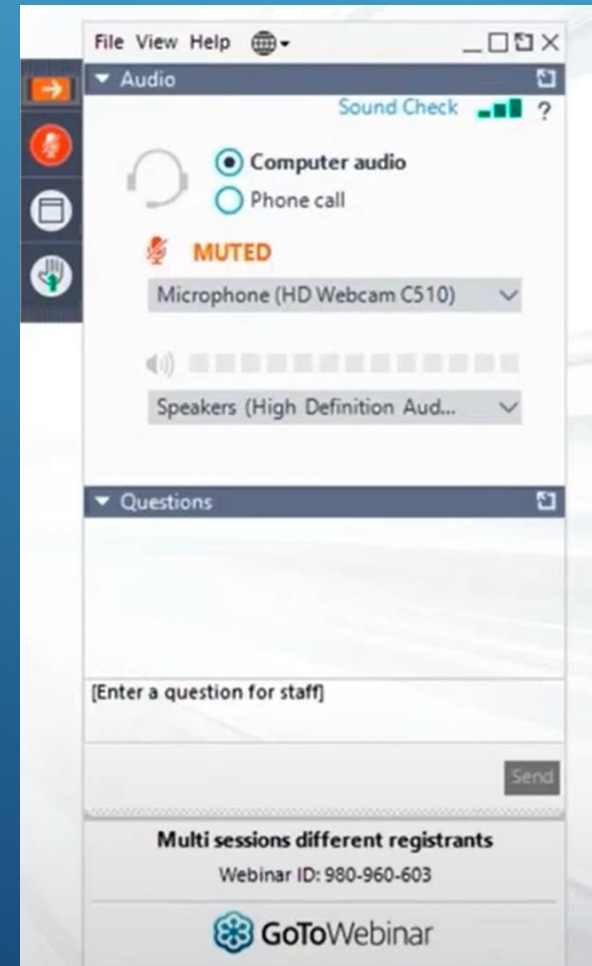

THE AGENDA FOR TODAY'S WEBINAR

1. Commuter Choice Maryland information & available tools & resources
2. Guest Speaker: Mr. Scott Ryser with Yakabod Federal Solutions
3. Q & A Session

POLL #1: PRE-COVID 19 DID YOU BIKE FOR ALL OF PART OF YOUR COMMUTE INTO WORK?

- A. Biked for part of my commute to work
- B. Biked for my entire commute to work
- C. Did not bike to work

POLL #2: POST-COVID 19 DO YOU ANTICIPATE BIKING TO WORK ?

- A. Yes
- B. No
- C. Not sure

POLL #3: WHAT DOES YOUR COMPANY DO TO SUPPORT BIKING TO WORK (CHOOSE ALL THAT APPLY)

- A. Provide showers
- B. Provide bike racks
- C. Provide covered bicycle parking or bike lockers
- D. Sponsor safe cycling classes
- E. Other

WHAT IS COMMUTER CHOICE MARYLAND?

Help reduce congestion & improve the quality of life of all Marylanders

Businesses and commuters can save money!

Congestion reduction & energy conservation



CommuterChoice
Maryland

Commuter Choice Maryland
Promotes alternatives to
driving alone

COMMUTER PROGRAM SERVICES



Transportation Options

- Serve as a resource for transportation options such as Guaranteed Ride Home, transit, vanpool, carpool, biking and walking, flexible work schedules and telework



Information

- Online and printed information on available resources on transportation options



Outreach

- Outreach to commuters at events to increase their knowledge and comfort level with using transportation options

Visit: CommuterChoiceMaryland.com to learn more

EMPLOYER PROGRAM SERVICES



Employer Assistance

- Provide ongoing assistance to employers in implementing commuter benefits programs and taking advantage of the Maryland Commuter Tax Credit



Webinar & Information

- Deliver webinars, provide toolkits, targeted materials to help employers with communications and implementing a commuter benefits program



Marketing Materials

- Provide marketing materials and information on employee commute options

Visit: CommuterChoiceMaryland.com to learn more

WHICH COMMUTE OPTION IS BEST FOR YOU?



Commuter Choice Maryland is the Maryland Department of Transportation (MDOT) Travel Demand Management Program. This program enables MDOT to address key goals, objectives, and strategies that will maximize traveler choices, and deliver transportation solutions and services that can reduce congestion, conserve energy, protect the environment, facilitate economic opportunity, enhance the quality of life for everyone while saving you money and reducing stress.

Address

Note: You may add exact address, nearby intersection, landmark or zip code.

Home

Work

Preferred Departure Time

Home To Work

Work To Home

Number of Days You Commute to Work Location Every Week

Vehicle Information

Vehicle Type

Vehicle Age

Vehicle Fuel



By changing mode to biking you could save monthly:

- \$16 in fuel cost
- \$6 in vehicle maintenance cost
- \$240 in parking cost

You could create annually environmental benefits:

- \$5 in emissions pollution reduction
- \$20 in GHG emissions reduction
- You could burn 69 additional calories daily

Commuter Calculator Available at: CommuterChoiceMaryland.com

FREE BUSINESS TOOLKITS

2019 Edition   MARYLAND DEPARTMENT OF TRANSPORTATION
"The Maryland Department of Transportation is a customer-driven leader that delivers safe, accessible, intelligent, and exceptional transportation solutions in order to connect our customers to life's opportunities."

Commuter Choice Maryland Maryland Employer Commuter Benefits

TOOLKIT



2019 Edition   MARYLAND DEPARTMENT OF TRANSPORTATION
"The Maryland Department of Transportation is a customer-driven leader that delivers safe, accessible, intelligent, and exceptional transportation solutions in order to connect our customers to life's opportunities."

Commuter Choice Maryland

VANPOOL TOOLKIT

For Employers and Commuters



2019 Edition   MARYLAND DEPARTMENT OF TRANSPORTATION
"The Maryland Department of Transportation is a customer-driven leader that delivers safe, accessible, intelligent, and exceptional transportation solutions in order to connect our customers to life's opportunities."

Commuter Choice Maryland A Guide to Telework for Employers



Available at: CommuterChoiceMaryland.com

ADDITIONAL BIKE RESOURCES



Help your Employees Enjoy Active Commutes!



What Benefits Should Be Provided Or Promoted?

Bikeshare Corporate Memberships

Employers located in Montgomery County should consider a corporate membership to the Capital Bikeshare program. Numerous stations are located in Bethesda, Silver Spring, and Rockville. This benefit provides employees with discounted or free bicycle access that can be used for daily commuting and travel to business meetings. Similarly, employers located in Howard County should consider purchasing membership for their employees to Howard County Bikeshare.

Want more info? <https://www.capitalbikeshare.com/corporate> and <https://howardcountybikeshare.com/>

Guaranteed Ride Home

Employers located in the Greater Baltimore/Washington DC-area are eligible for the Guaranteed Ride Home Program. For those commuters who regularly travel to work on foot or by bike, this program provides a free ride home four times a year in the event of emergencies (personal illness, an unexpected family emergency, or unscheduled overtime).

Want more info? <https://www.mta.maryland.gov/GRH>

Bicycle Benefit

Beginning in 2018, the Bicycle Commuter Tax Benefit program was created for employers as a way to deduct costs associated with providing bicycle commuting options for employees (Sec. 13304(c)(2) of the Tax Cuts and Jobs Act). Any reimbursement given to employees under Bicycle Commuter Tax Benefit program is taxable as income to the employee.

Want more info? <https://www.bikeleague.org/content/bicycle-commuter-benefit>



Why Offer Commuter Benefits for Bike and Walk?

There are plenty of reasons why employers should support active transportation. Bicycling and walking are attractive and efficient options for commuting to work. Why commute by bicycling or walking?

Health

When you promote active transportation, you are enhancing the health of your workforce. A great deal of research demonstrates the positive benefits of walking and bicycling for human health. Improved health translates to increased productivity as employees miss less days of work, and both businesses and individuals experience reduced healthcare costs. According to a 2018 survey, health was the number one motivating factor for Maryland residents walking to work.

Environment

Active transportation is the most environmentally friendly way to commute to work. According to the most recent figures from the EPA, non-active transportation is responsible for over 25% of US greenhouse gas emissions. Employees can play a role in reducing greenhouse gas emissions that are harmful to human health and the environment by opting to bicycle and walk to work. These efforts are also beneficial in accomplishing corporate sustainability goals.

Economic

While non-active transportation costs account for a significant portion of an employee's annual expenses, walking and bicycling is the most cost-effective mode of commuting. Eliminating the need to pay for gas, tolls, parking fees, auto maintenance, and transit fares saves your employees money!



How can I learn more?



Web CommuterChoiceMaryland.com
Phone 410-865-1100
Hours (M-F from 8:30 a.m. – 5:00 p.m.)
Email CommuterChoice@mdot.maryland.gov

Sign up with Commuter Choice Maryland to access assistance with your commuter benefits program and receive regular updates and information on employer and commuter transportation resources!

Available at: CommuterChoiceMaryland.com



WEBINAR BENEFITS OF BIKE & WALK FRIENDLY WORKPLACES

CommuterChoice
Maryland

MDOT
MARYLAND DEPARTMENT
OF TRANSPORTATION

Benefits of Bike & Walk Friendly Workplaces

Building a culture of bike commuting, May 22, 2019 Webinar

Webinar Recording Available: CommuterChoiceMaryland.com

GUARANTEED RIDE HOME FOR BIKERS ALSO!

What is it?

- Registered Commuters can qualify for up to four free ride home a year if they carpool, vanpool, take transit, **bike** or walk to work at least twice a week.
- Visit:
CommuterChoiceMaryland.com



GUARANTEED
RIDE HOME
• PROGRAM •

It's cool. We got this.
One less thing to worry about.

You will get home. Guaranteed
Guaranteed Ride Home is a free service.
commuterconnections.org

MDOT
MARYLAND DEPARTMENT
OF TRANSPORTATION

 **CommuterChoice**
Maryland

COMMUTER CONNECTIONS
MAKING THE WAY TO WORK



BUSINESS SPOTLIGHTS



Pictured Above: UMD Vanpools. Vanpooling along with cycling, transit, and telework, has been an effective tool in helping UMD reduce demand for parking on campus.



EMPLOYER PROFILE

EXPANDING CAMPUS WHILE REDUCING PARKING: THE UMD STORY

The University of Maryland (UMD) is committed to addressing climate change. As one of the initial signatories of the 2007 American College & University Presidents Climate Commitment (now called the Carbon Commitment), the University developed a Climate Action Plan in 2009 with the goal of being a carbon neutral campus by the year 2050. At the same time, the flagship College Park campus has experienced dramatic growth, with ten new or significantly renovated buildings completed in the past decade. On a densely populated urban campus, options are limited for siting new buildings and as a result some existing parking lots were replaced with new buildings. The University's robust sustainability goals, combined with the campus' changing landscape, meant that the UMD Department of Transportation Services (DOTS) needed a strategy for reducing the number of people who drive alone to UMD. "While we know that parking is still a necessity on our campus, we've made it a priority to introduce alternative commute options to our community," says Anna McLaughlin, DOTS Assistant Director of Sustainability.

DOTS understood that no single initiative would motivate solo drivers to change their commute. It also had a head start in the form of Shuttle-UM, its existing network of shuttle services that connect the campus to the College Park MetroRail Station and many other off-campus transportation and activity hubs. In September 2017, DOTS launched its Smart Commute program, which incentivizes the University community to commute by using sustainable transportation, such as walking, cycling, ridesharing or taking transit. Under this program, DOTS implemented carpool initiatives, offering up to a 50 percent reduction in parking fees for employees who committed to carpooling every day. They offer pre-tax benefits for transit users, and implemented a bicycle incentive program, which provides covered bike parking on campus and free shower facilities to people who bike to campus. They started offering carsharing on campus, which makes it easier for resident students to live free.



YAKABOD

Live!
CASINO • HOTEL
MARYLAND

SMECO
People. Power. Progress.



AOPA
your freedom to fly



Read more stories: CommuterChoiceMaryland.com



LET COMMUTER CHOICE MARYLAND HELP TODAY!

- Contact Commuter Choice Maryland for any assistance needed
- Provide bike maps & cycling information
- Create a plan for implementation
- Take advantage of the many tools
- Sign up for Guaranteed Ride Home

COMMUTER CHOICE MARYLAND GUEST

Mr. Scott Ryser



- Founder and CEO of Yakabod Federal Solutions.
- Yakabod earned a Bicycle Friendly Designation from the league of American Bicyclists.
- Was recently featured in Commuter Choice Maryland's Business Spotlight for their leading role as a Bike Friendly Workplace.



- ▶ COMMUTE
- ▶ CONNECT
- ▶ COMMUNITY
- ▶ CULTURE



Questions?

Please type your questions
in the question window

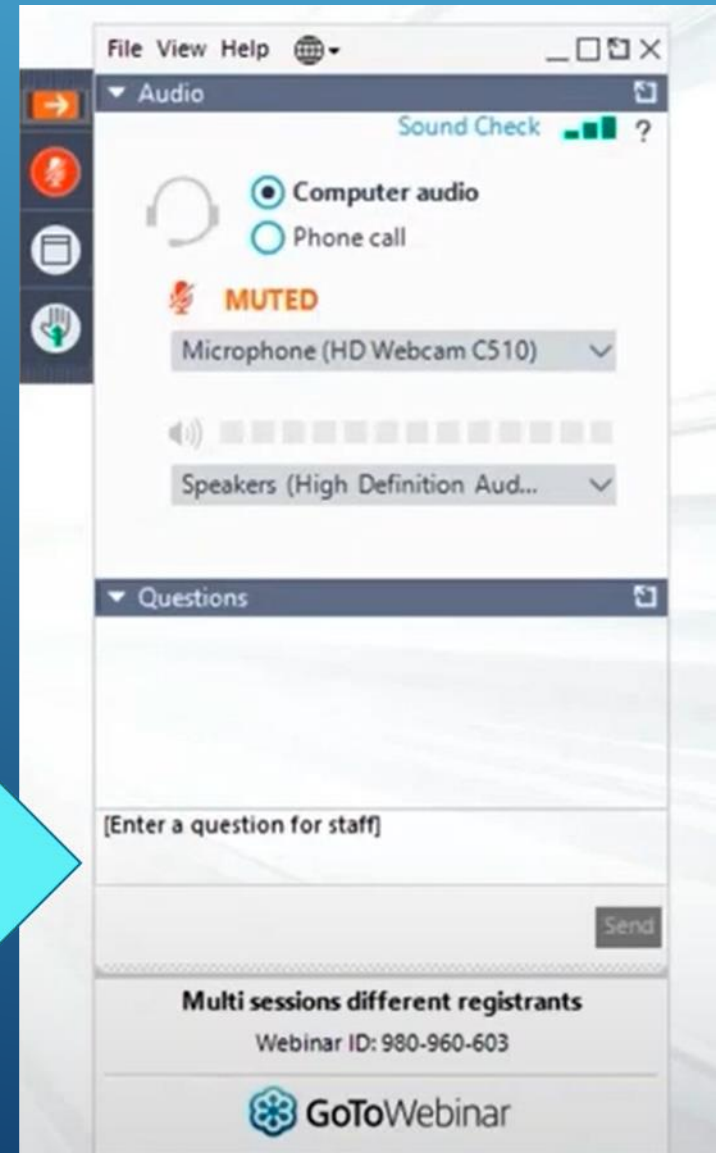
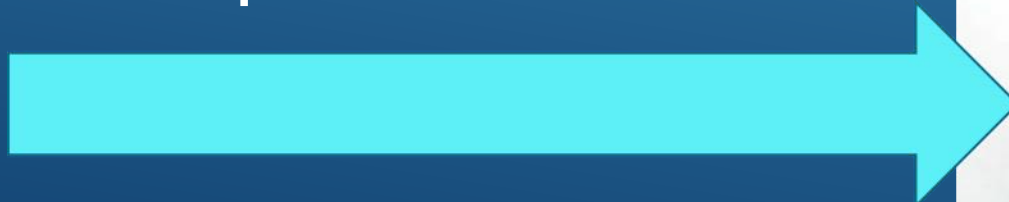

Thank You!

Contact Details:

Commuter Choice Maryland

Phone: 410-865-1100

Email: Commuterchoice@Mdot.Maryland.gov

Website: CommuterChoiceMaryland.com

Follow & Like us!



<https://www.linkedin.com/in/commuterchoicemd/>



Facebook:
[@CommuterChoiceMaryland](https://www.facebook.com/CommuterChoiceMaryland)